

Title:
Scale: 1:1250
User ID:
Date: 24/07/2015
Grid Ref: 431406,562915
Internal Use Only

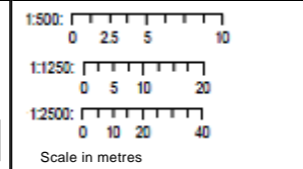

This plan shows those pipes owned by Northern Gas Networks or the relevant Gas Distribution Network in their roles as Licensed Gas Transporters (GT). Gas pipes owned by other GTs, or otherwise privately owned, may be present in this area. Information with regard to such pipes should be obtained from the relevant owners. The information shown on this plan is given without warranty, the accuracy thereof cannot be guaranteed. Service pipes, valves, syphons, stub connections, etc. are not shown but their presence should be anticipated. No liability of any kind whatsoever is accepted by Northern Gas Networks, the relevant Gas Distribution Network, or their agents, servants or contractors for any error or omission. Safe digging practices, in accordance with HS(G)47, must be used to verify and establish the actual position of mains, pipes, services and other apparatus on site before any mechanical plant is used. It is your responsibility to ensure that this information is provided to all persons (either direct labour or contractors) working for you on or near gas apparatus. The information included on this plan should not be referred to beyond a period of 28 days from the date of issue.

This plan is reproduced or based on the OS map by Northern Gas Networks, with the sanction of the controller of HM Stationary Office. Crown Copyright Reserved.

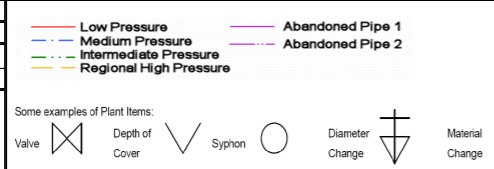
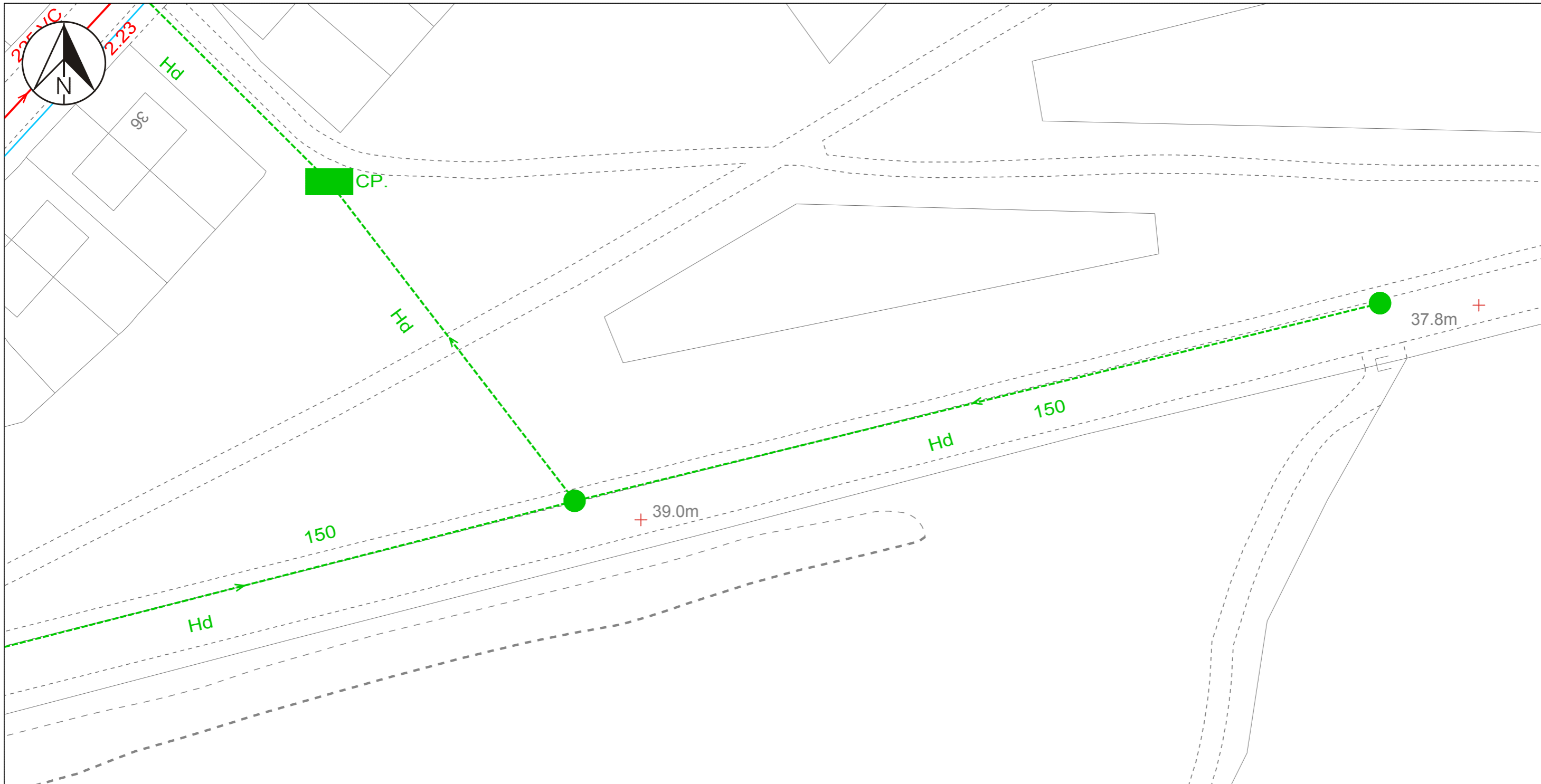

Waste Water -		NWL Responsibility		Private/Non NWL		Proposed		Water Network -		Network Types	
Combined	—	Combined	—	Combined	—	Combined	—	Distribution	—	AB Asbestos	—
Foul	—	Foul	—	Foul	—	Foul	—	Treated	—	Abandoned	—
Surface	—	Surface	—	Surface	—	Surface	—	Raw	—	Out of Comm	—
Treated Eff	—	Trade Eff	—	Watercourse	—			Supply	—		
Untreated Eff	—							Private	—		
Overflow	—										



User : GISNGN

Date : 24/07/2015 07:40:25

Map Sheet : NZ3162NW

Title :

Centre Point : 431406,562912

Paper / Scale : A3@1:500

The material contained on this plot has been reproduced from an Ordnance Survey map with permission of the controller of H.M.S.O. Crown Copyright Reserved. Licence No. WU298506 The information shown on this plan should be regarded as approximate and is intended for guidance only. No Liability of any kind whatsoever is accepted by Northumbrian Water, it's servants or agents for any omission. The actual position of any water mains or sewers shown on the plan must be established by taking trial holes in all cases. In the case of water mains Northumbrian Water must be given two working days notice of their intention to excavate trial holes. Private connections are not shown but their presence should be anticipated. WARNING...Where indicated on the plan there could be abandoned asbestos cement materials or shards of pipe. If excavating in the vicinity of these abandoned asbestos cement materials, the appropriate Health & Safety precautions should be taken. Northumbrian Water accepts no liability in respect of claims, costs, losses or other liabilities which arise as the result of the presence of the pipes or any failure to take adequate precautions. Emergency Telephone Number: 0845 717 1100



Maps by email Plant Information Reply

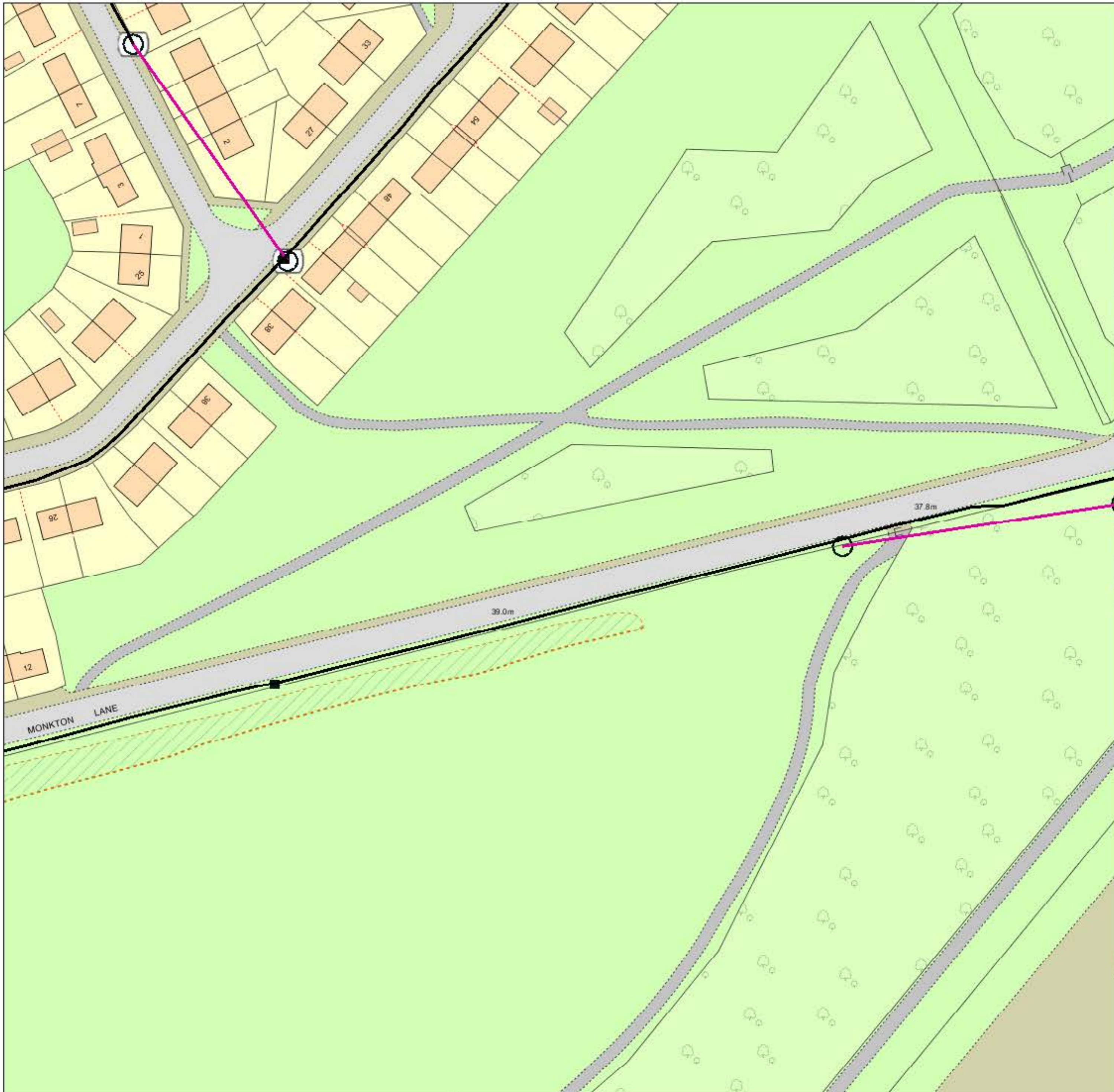

IMPORTANT WARNING

Information regarding the location of BT apparatus is given for your assistance and is intended for general guidance only. No guarantee is given of its accuracy.

It should not be relied upon in the event of excavations or other works being made near to BT apparatus which may exist at various depths and may deviate from the marked route.

DIAL BEFORE YOU DIG

FOR PROFESSIONAL ON SITE ASSISTANCE PRIOR TO COMMENCEMENT OF EXCAVATION WORKS

ADVANCE NOTICE REQUIRED
(Office hours: Monday-Friday 08.00 to 17.00)

Tel: 0800 9173993
E-mail: dbyd@openreach.co.uk
Website: www.dialbeforeyoudig.com

Reproduced from the Ordnance Survey map by BT by permission of Ordnance Survey on behalf of the Controller of Her Majesty's Stationary Office
(C) Crown Copyright British Telecommunications plc 100028040

KEY TO BT SYMBOLS

	UNDERGROUND PLANT		POLE
	OVERHEAD PLANT		CABINET
	JOINT BOX		BURIED JOINT
	DISTRIBUTION POINT		JOINTING POST
	MANHOLE		PROPOSED U/G
	DP BOUNDARY		PROPOSED O/H
	OTHER BT BOUNDARY		PROPOSED BOX

Other proposed plant is shown using dashed lines. BT symbols not listed above may be disregarded. Existing BT plant may not be recorded. Information valid at the time of preparation.

openreach
a BT Group business



BT Ref : WMN07337A

Map Reference : (centre) NZ3140662912

Easting/Northing : (centre) 431406,562912

Issued : 24/07/2015 07:33:58

FOOTNOTE: WARNING IT IS ESSENTIAL THAT YOU CONTACT NATIONAL NETWORK HANDLING CENTRE BY EMAIL nnhc@openreach.co.uk BEFORE PROCEEDING WITH ANY WORK IN THE HATCHED AREA



			<p>_____</p>	<p>_____</p>	<p>_____</p>
<p>_____</p>	<p>_____</p>	<p>_____</p>	<p>_____</p>	<p>_____</p>	<p>_____</p>

17.9.92 JH
 11.7.89
 20.4.82 C.P

REVISIONS

Playing Field

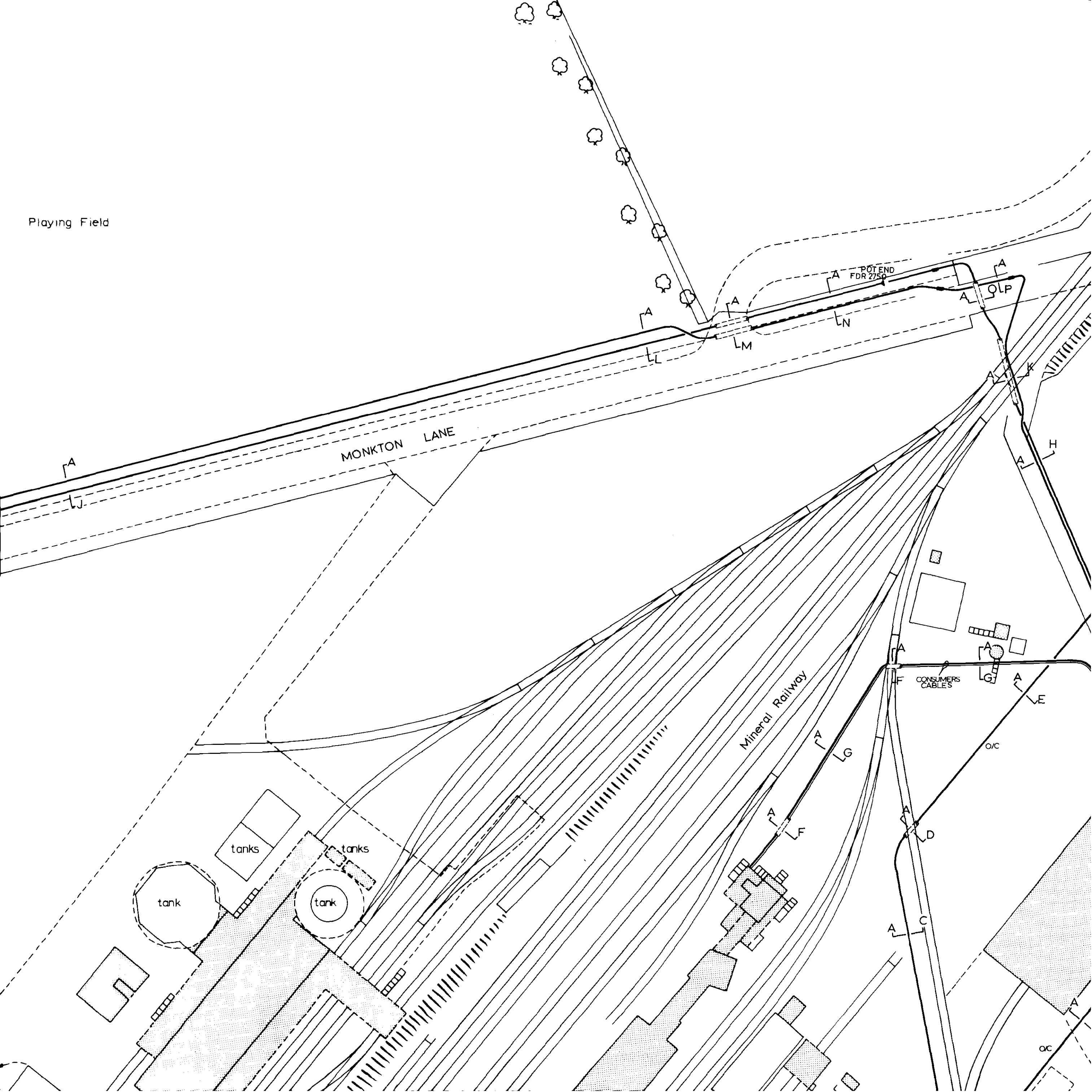

<p>A-B</p>	<p>A-C</p>	<p>A-D</p>	<p>A-E</p>	<p>A-F</p>	<p>A-G</p>
<p>A-H</p>	<p>A-J</p>	<p>A-K</p>	<p>A-L</p>	<p>A-M</p>	<p>A-N</p>
<p>A-O</p>	<p>A-P</p>	<p>A-</p>	<p>A-</p>	<p>A-</p>	<p>A-</p>
<p>A-</p>	<p>A-</p>	<p>A-</p>	<p>A-</p>	<p>A-</p>	<p>A-</p>

17.9.92 JH
 11.7.89
 21.4.82 C.P.

REVISIONS

Enquirer			
Name	Mr Daniel Stephenson	Phone	07816858653
Company	Northern Gas Networks	Mobile	Not Supplied
		Fax	Not Supplied
Address	Pottery Fields House Kidacre Street Hunslet Leeds West Yorkshire LS10 1BD		
Email	dstephenson@northerngas.co.uk		
Notes	Please ensure your contact details are correct and up to date on the system in case the Asset Owners need to contact you. Where Asset Owners charge for plans they have been requested to send you a quote before proceeding.		

Enquiry Details			
Scheme/Reference	Utilities		
Enquiry type	Planned Works	Work category	Utility Works
Start date	25/07/2015	Work type	Linear project cross country
End date	01/08/2015	Site size	32552 metres square
Searched location	XY= 431406, 562912 Easting/Northing	Work type buffer*	25 metres
Confirmed location	431432 562920		

* The WORK TYPE BUFFER is a distance added to your search area based on the Work type you have chosen

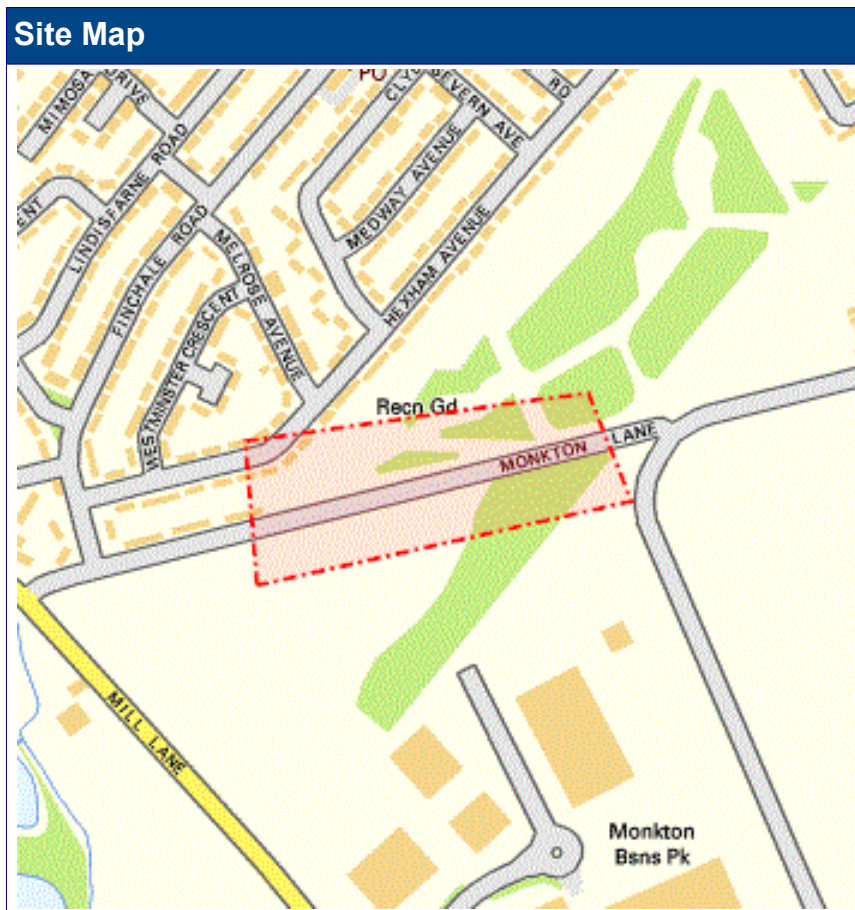

Asset Owners

Subject always to our standard terms and conditions, this enquiry result is valid for 28 days only from the date of enquiry and is based on the confirmed information you entered. If the location of the work changes then a further enquiry must be made. Should the work not be undertaken within 28 days of the enquiry then a further enquiry must be made.

Where applicable listed below are those registered Asset Owners who have been notified, those to whom you need to send further information and those who have no apparatus within your search area. In addition your response will include other non-registered Asset Owners contact details who have NOT been notified, which may be of interest to you.

Please be aware that the lists below are not exhaustive and that not all Asset Owners are registered with this service. In particular please note that the LineSearchbeforeUdig system only contains information on National Grid's Gas above 2 bar asset and all National Grid Electricity Transmission asset. For National Grid Gas below 2 bar asset information please go to www.beforeudig.nationalgrid.com

**If you are required to email additional info please note that we need the following:
Site contact name and number, Location plan, Detailed plan (minimum scale 1:2500), Cross sectional drawings (if available), Work Specification.**

Asset Owners who DO have assets near your proposed work site.

In the Zone of Interest			
Asset Owner	Phone/Email	Emergency Only	Status
Northumbrian Water Limited	01913016954	08702417408	Notified

LineSearchbeforeUdig Asset Owners who DO NOT have assets in the immediate vicinity of your proposed work site.

Not in the Zone of Interest		
AWE Pipeline	Esso Petroleum Company Limited	Oikos Storage Limited
BOC Limited (A Member of the Linde Group)	FibreSpeed Limited	Perenco UK Limited (Purbeck Southampton Pipeline)
BP Midstream Pipelines	Gamma	Phillips 66
BPA	Humbly Grove Energy	Premier Transmission Ltd (SNIP)
Carrington Gas Pipeline	HV Cables	Redundant Pipelines - LPDA
Centrica Energy	IGas Energy	RWEpower (Little Barford and South Haven)
Centrica Storage Ltd	Ineos Enterprises Limited	SABIC UK Petrochemicals
CLH Pipeline System Ltd	INEOS Manufacturing (Scotland and TSEP)	Scottish Power Generation
ConocoPhillips (UK) Ltd	Lark Energy	Seabank Power Ltd
Coryton Energy Co Ltd (Gas Pipeline)	Lightsource SPV Limited	Shell Pipelines
CSP Fibre c/o Centara	Mainline Pipelines Limited	Total (Finaline, Colnbrook & Colwick Pipelines)
EirGrid	Manchester Jetline Limited	Transmission Capital
Electricity North West Limited	Manx Cable Company	Vattenfall
E-on UK Plc (Gas Pipelines Only)	Marchwood Power Ltd (Gas Pipeline)	Western Power Distribution
ESP Utilities Group	National Grid Gas (above2 bar) and National Grid Electricity Transmission	Wingas Storage UK Ltd
ESSAR	NPower CHP Pipelines	Zayo Group UK Ltd c/o JSM Group Ltd

The following Asset Owners are NOT currently members of LineSearchbeforeUdig, however you should contact them before proceeding. Please be aware that this list is not exhaustive and that **IT IS YOUR RESPONSIBILITY TO IDENTIFY AND CONTACT ALL ASSET OWNERS WITHIN YOUR SEARCH AREA.**

Not Notified			
Asset Owner	Preferred contact method	Phone	Status
BskyB Telecommunications	nrswa@bskyb.com	02070323234	Not Notified
BT	https://www.swns.bt.com/pls/mbe/welcome.home	08009173993	Not Notified
Colt	plantenquiries@catelecomuk.com	01227768427	Not Notified
Energetics Electricity	plantenquiries@energetics-uk.com	01698404646	Not Notified
Fulcrum	FPLplantprotection@fulcrum.co.uk	03330146455	Not Notified
GTC	https://pe.gtc-uk.co.uk/PlantEnqMembership	01359240363	Not Notified
Instalcom	plantenquiries@instalcom.co.uk	02087314613	Not Notified
Interoute	interoute.enquiries@plancast.co.uk	02070259000	Not Notified
Northern Gas Networks	plantprotection@northerngas.co.uk	01915014349	Not Notified
Northern Powergrid	Safediggingplans@northernpowergrid.com	01912294294	Not Notified
Tata, KPN (c/- McNicholas)	plantenquiries@mcnicholas.co.uk	03300558469	Not Notified
Verizon Business	osp-team@uk.verizonbusiness.com	01293611736	Not Notified
Virgin Media	http://www.digdat.co.uk	08708883116	Not Notified
Vodafone	osm.enquiries@atkinsglobal.com	01454662881	Not Notified
Vtesse Networks	https://vtplant.vtesse.com	01992532100	Not Notified

Disclaimer

The results of this Enquiry have been provided for the sole use of the Enquirer and no other party. The asset information on which the Enquiry results are based has been provided by LineSearchbeforeUdig members, LineSearchbeforeUdig will provide no guarantee that such information is accurate or reliable nor does it monitor such asset information for accuracy and reliability going forward. There are also asset owners which do not participate in the enquiry service operated by LineSearchbeforeUdig, including but not exclusively those set out above. Therefore, LineSearchbeforeUdig cannot make any representation or give any guarantee or warranty as to the completeness of the information contained in the enquiry results.

LineSearchbeforeUdig and its employees, agents and consultants accept no liability (except insofar as liability under any statute that cannot be excluded) arising in respect thereof or in any other way for errors or omissions including responsibility to any person by reason of negligence. Please refer to LineSearchbeforeUdig's Terms of Use for full terms of use available at www.linesearchbeforeudig.co.uk

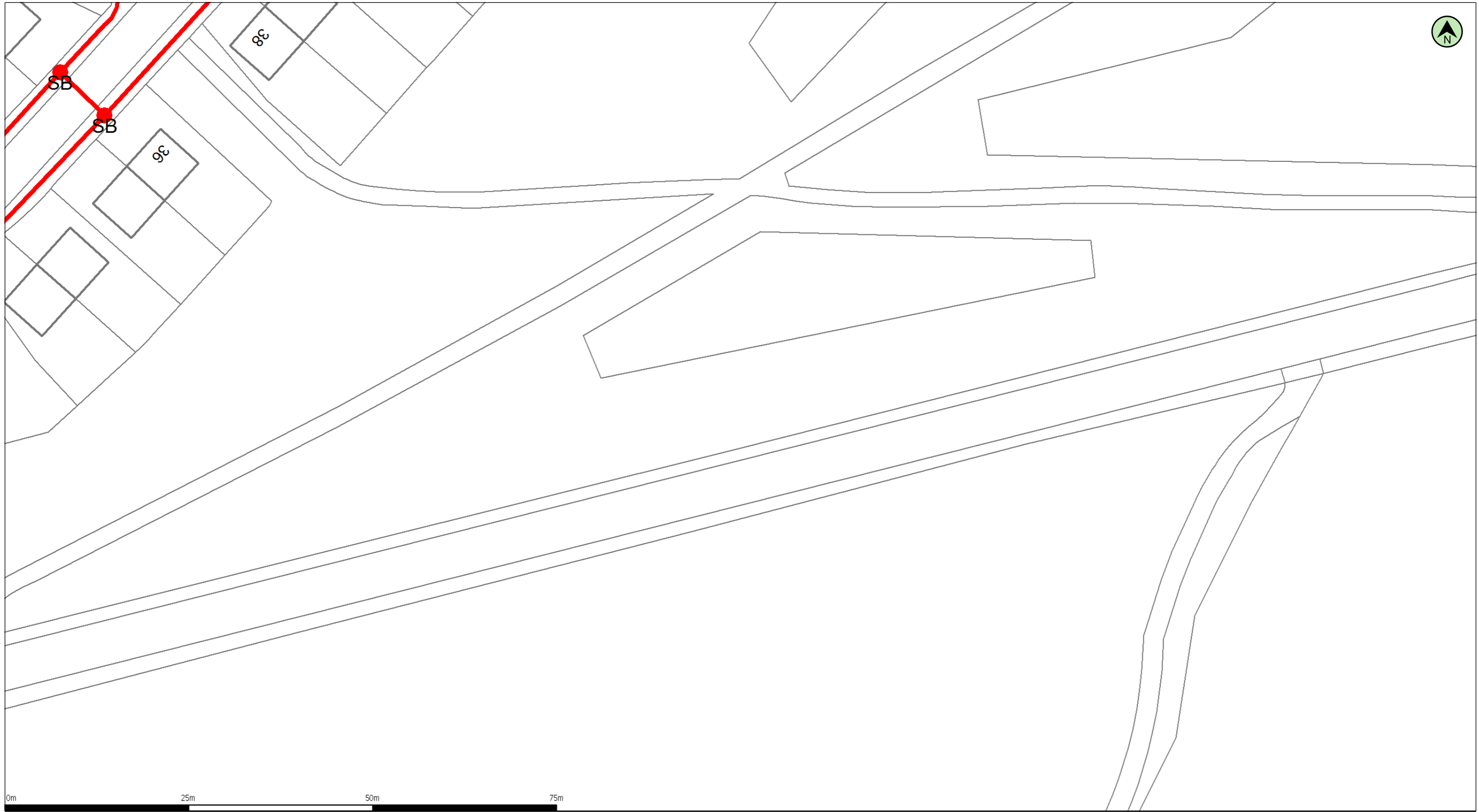

(c) Crown copyright and database rights 2015 Ordnance Survey 100019209 Date: 24/07/15 Scale: 1:500 Map Centre: 431406,562912 Data updated: 28/06/15 Telecoms Plan A3

Important Information - please read
 The purpose of this plan is to identify Virgin Media apparatus. We have tried to make it as accurate as possible but we cannot warrant its accuracy. In addition, we caution that within Virgin Media apparatus there may be instances where mains voltage power cables have been placed inside green, rather than black ducting. Further details can be found using the 'Affected Postcodes.pdf', which can be downloaded from this website. Therefore, you must not rely solely on this plan if you are carrying out any excavation or other works in the vicinity of Virgin Media apparatus. The actual position of any underground service must be verified by cable detection equipment, etc. and established on site before any mechanical plant is used. Accordingly, unless it is due to the negligence of Virgin Media, its employees or agents, Virgin Media will not have any liability for any omissions or inaccuracies in the plan or for any loss or damage caused or arising from the use of and/or any reliance on this plan. This plan is produced by Virgin Media Limited (c) Crown copyright and database rights 2015 Ordnance Survey 100019209.

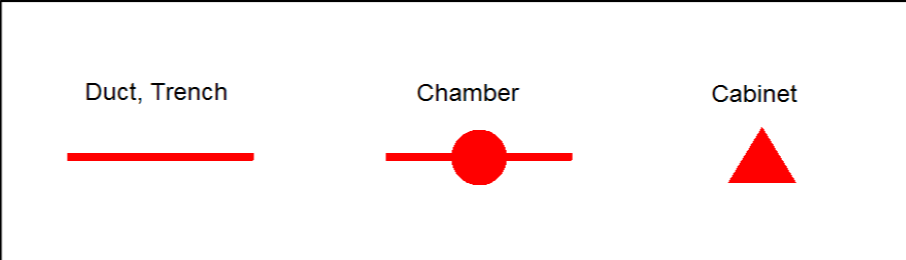

dstephenson@northerngas.co.uk

